

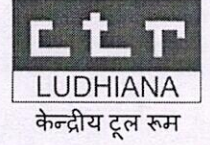

CENTRAL TOOL ROOM, LUDHIANA
Ministry of Micro Small & Medium Enterprises
Government of India
केन्द्रीय टूल रूम
सुक्ष्म, लघु एवं मध्यम उद्योग मंत्रालय.
भारत सरकार



Ref No. CTR/LDH/1810/Mach/2022-43

Dated: 03.08.2022

Subject: CALL FOR QUOTATION

Dear Sir/Sirs,

Quotations for the following civil work is invited, which should reach in Purchase Department, Central Tool Room, A-5 Focal Point, Dhandari Kalan, Ludhiana-141010 not later than-

Last date of receipt of Quotations: 10.08.2022

| Sr. No. | Description of items | Qty. |
|---------|---|--------|
| 1. | Surface dressing and cement concrete sub base and Brick edge flooring of area 10.5 x 3.5 meter. | 01 Job |
| 2. | Construction of shed of area 11.0 x 4.0 meters. (Drawing enclosed) | 01 Job |

Yours faithfully,

(Gaurav Bansal)
HOD/Purchase

Terms and Conditions-

1. The rate shall be quoted F.O.R. destination, Nilokheri (Haryana)
2. GST and other Govt. levies, if applicable, should be mentioned clearly
3. GSTIN should be clearly mention in quotation.
4. The Quotation shall be valid for 45 days from date of opening.
5. Delivery period and Payment term should to be mentioned clearly.
6. Any other charges should be quoted extra.
7. HOD-Purchase reserves the right to accept or reject any or all quotation without assigning any reason.

A-5, Focal Point, Ludhiana - 141010
Tel: (+91)-0161- 2670059 (Ext. 237), 2670058, 2676166, 2673564
Fax: (+91)-0161-2674746.
E-mail: info@ctrludhiana.com ; Visit us at : www.ctrludhiana.com

Flooring and Shed Drawing of Welding Lab

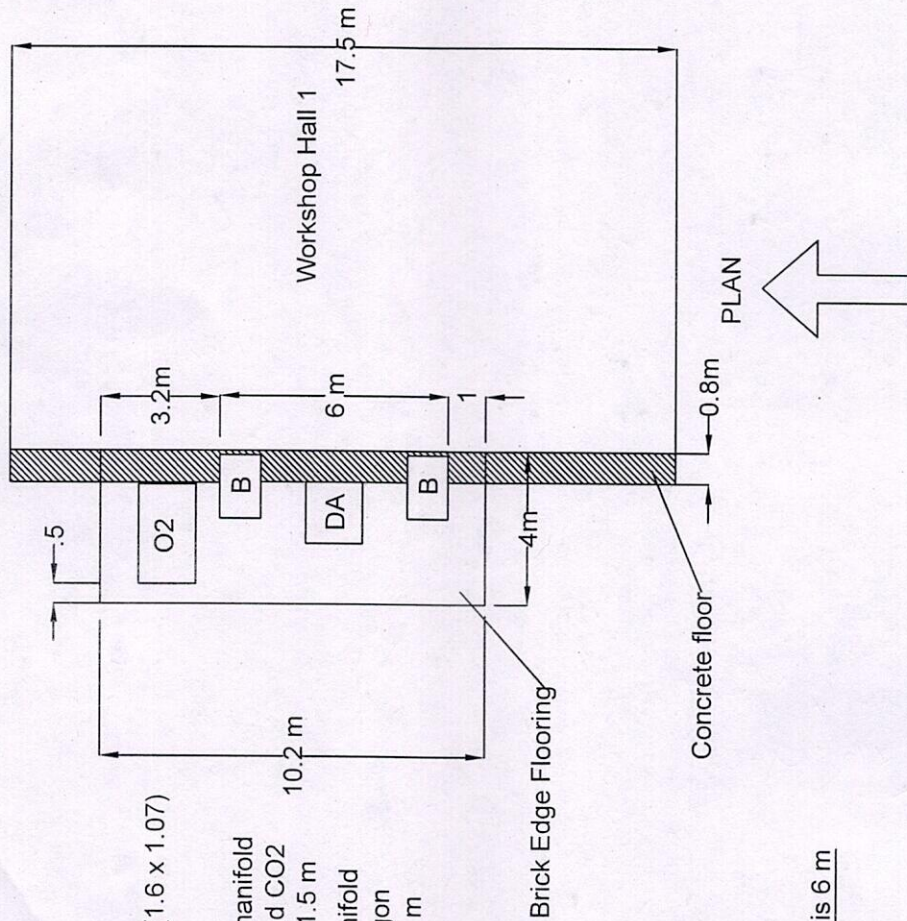

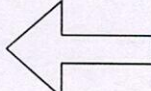
PLAN 

- B Blower (1.6 x 1.07)
- O2 Gas manifold O2 and CO2 2.6 x 1.5 m
- DA Gas manifold DA & argon 1.6 x 1.5 m

Note: Height of the shed is 6 m